

# SYSTEM BASICS

## Home/Sleep/Away System with Touchscreen Keypad

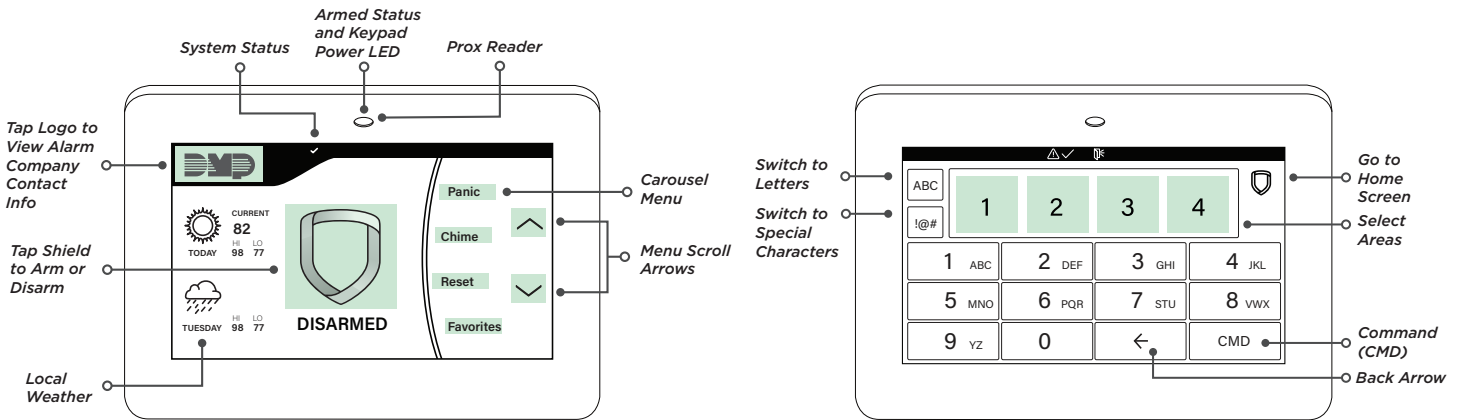

**Zone:** A point of detection such as a door, window, motion detector, or sensor.

**Area:** A group of zones. For a Home/Sleep/Away system, these areas are: The perimeter (Home), perimeter plus interior except nighttime areas (Sleep), and perimeter plus all interior areas (Away).

## Arm the System

- 1 Tap the shield in the center of the keypad.
- 2 Select an arming type. For Home/Away systems, **SLEEP** is not in the list of options.
  - ▶ **If you're at home:** Tap **HOME**. This arms the perimeter of your house. After arming, the keypad displays **HOME SYSTEM ON**.
  - ▶ **If you're at home and staying in nighttime areas:** Tap **SLEEP**. This arms everything except nighttime areas like bedrooms. After arming, the keypad displays **SLEEP SYSTEM ON**.
  - ▶ **If you're leaving your home and no one will remain inside:** Tap **AWAY**. This arms all areas. After arming, the keypad displays **ALL SYSTEM ON**.

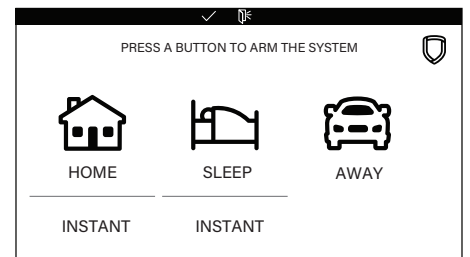
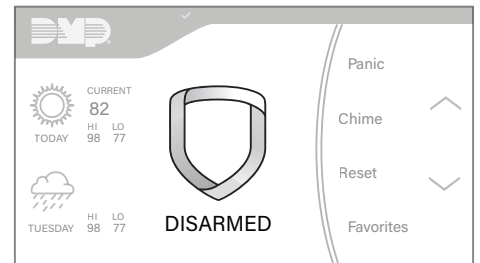

- 3 If **ENTER CODE** displays, enter your user code and tap **CMD**.

# Faulted Zones

A zone is *faulted* when it isn't working correctly and the system can't arm it. This could be something like a door being open or a motion detector sensing movement while the system is trying to arm. When a zone is faulted, you have three options: Force it to arm, bypass it, or stop arming so you can fix it.

- ▶ To force the zone to arm so it becomes part of the protected area when it returns to normal, tap **OKAY**.
- ▶ To bypass the zone so it stays bypassed until the next time the system is armed, tap **BYPASS**. Panic, emergency, fire, flood detector, and temperature sensor zones can't be bypassed.
- ▶ To stop the system from arming so you can fix the problem, tap **STOP**. Fix the problem, then try to arm again.

# Disarm the System

## *During Normal Operation*

- 1 Tap the shield in the center of the keypad.
- 2 At **ENTER CODE**, enter your user code and tap **CMD**. When the system is disarmed, the keypad displays **ALL SYSTEM OFF**, then returns to the home screen.

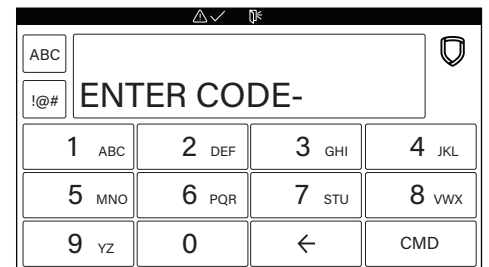
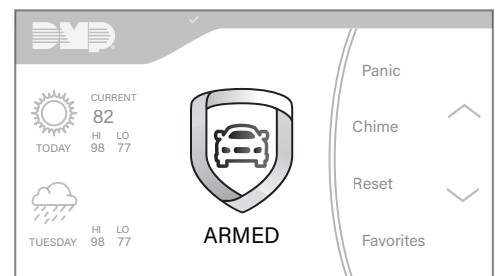

## *During an Alarm*

- 1 Tap the shield in the center of the keypad.
- 2 At **ENTER CODE**, enter your user code and tap **CMD**.
- 3 The system displays **IS THIS A FALSE ALARM? NO YES**.
  - ▶ **For a Real Alarm:** Tap **NO**. This confirms the alarm and notifies the monitoring center that a real alarm is happening. Your security system stays armed.
  - ▶ **For a False Alarm:** Tap **YES**. This cancels the alarm and sends an abort message to the monitoring center. Your security system disarms. The keypad displays **ALL SYSTEM OFF**, then returns to the home screen.

